

4" (100mm) Twin Skinned Flat Lath Section

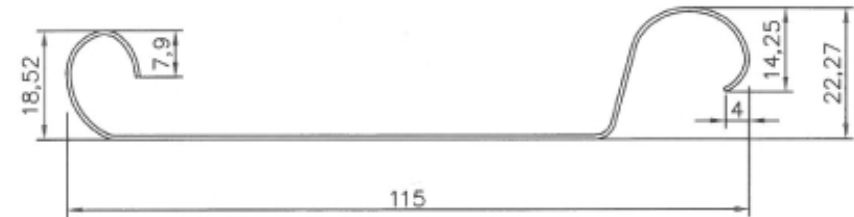

100mm flat insulated lath section

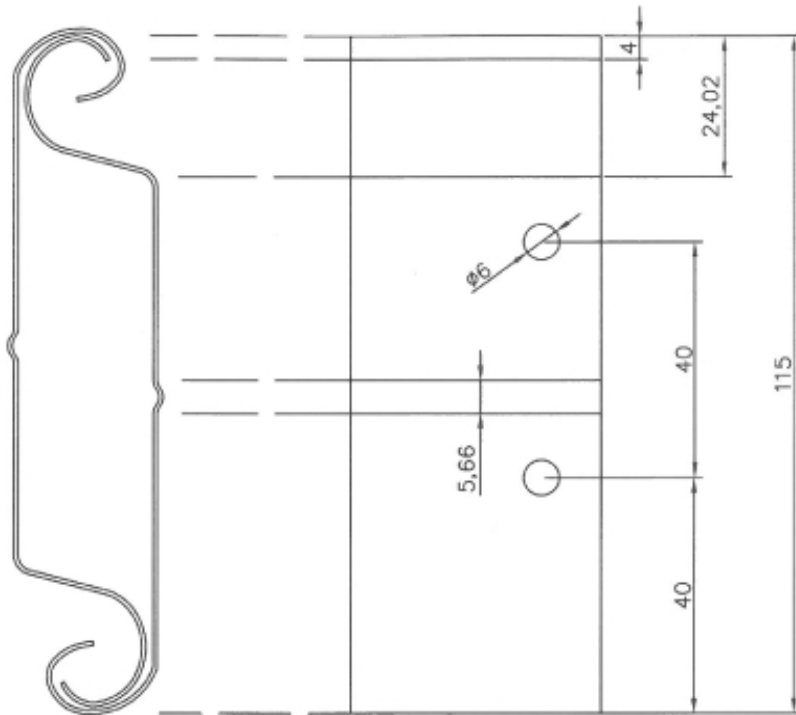
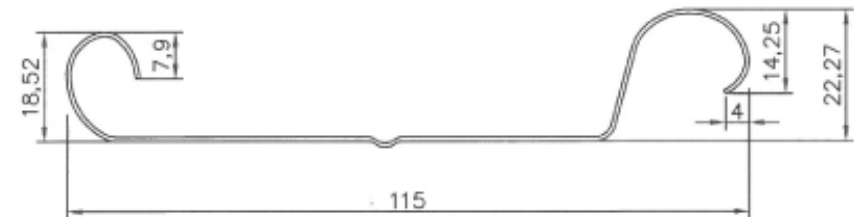

100mm ribbed insulated lath section

| 75mm & 100mm Supalath Section | | | |
|-------------------------------|------------------|---------------|------------|
| Section | Strip Width (mm) | Weight (kg/m) | Gauge (mm) |
| 75mm Supalath Galv | 141 | 0.7800 | 0.7000 |
| 75mm Supalath Plastisol | 141 | 0.8000 | 0.7000 |
| 100mm Supalath Galv | 166 | 0.9100 | 0.7000 |
| 100mm Supalath Plastisol | 166 | 0.9300 | 0.7000 |

Fox Industrial Doors Ltd
 Head Office Address:
 Chapel House
 Queen Street
 Stourton
 Leeds
 LS10 1SL
 United Kingdom
 Landline: 0113 320 1000
 Mobile: 0796 801 4668